



Steynton Avenue, Bexley, Kent, DA5 3HN

Guide Price Range £700,000 - £725,000

Park Estates are delighted to offer this extended 4/5 bedroom semi detached chalet house, situated within a popular location within a short walk of Albany Park shops & station. This very well presented family home comprises of lounge, dining room which leads into an extended fully fitted Kitchen, ground floor bathroom and a 5th bedroom or 3rd reception room. To the first floor there are 4 spacious bedrooms and a shower room. In addition the property also features a rear garden, plenty of off road parking, double glazing and gas central heating.

Your early viewing would be very highly recommended.

Steynton Avenue, DA5
Approximate Gross Internal Area = 134 sq m / 1441 sq ft

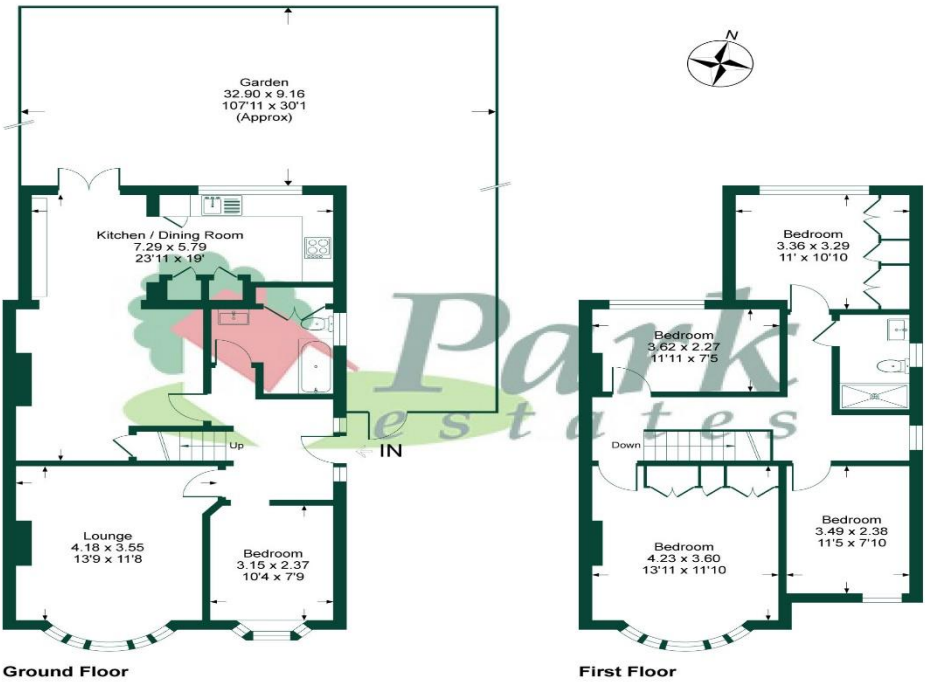

This plan is for layout guidance only. Not drawn to scale unless stated. Windows and door openings are approximate. Whilst every care is taken in the preparation of this plan, please check all dimensions, shapes and compass bearings before making any decisions reliant upon them.
Produced by Planpix

Energy Efficiency Rating			
Score	Energy rating	Current	Potential
92+	A		
81-91	B		84 B
69-80	C		
55-68	D	68 D	
39-54	E		
21-38	F		
1-20	G		

Council Tax
Band E.



